



# Pocket Parks

Upgrading Landscaped City-Owned Properties to Parks

# What is a Pocket Park?

- Pocket parks are urban open space on a small scale often created out of vacant lots or otherwise forgotten spaces<sup>1</sup>
- Pocket parks provide important public space in areas with high-density land use and areas deficient in open space<sup>2</sup>

1. Source: [http://depts.washington.edu/open2100/pdf/2\\_OpenSpaceTypes/Open\\_Space\\_Types/pocket\\_parks.pdf](http://depts.washington.edu/open2100/pdf/2_OpenSpaceTypes/Open_Space_Types/pocket_parks.pdf)

2. <http://www.sfbetterstreets.org/find-project-types/reclaiming-roadway-space/street-and-sidewalk-parks/>

# Proposed Action:

## Convert Landscaped Areas into Parks

- Staff has identified two highly visible parcels that are not parks but receive park-like usage which could be converted
  - 4<sup>th</sup> and Q Street
  - Broadway and Fairfield
- These parcels are already managed by the Parks Division & designating them as parks would allow us to run them like parks



# 4<sup>th</sup> & Q Street



Approximately 13,000 sq. ft.

Has a sidewalk along 4<sup>th</sup> Street and a path along the south side of the property

Within ~150 feet of a bus stop

Highly visible to commuters on Highway 101

**Name Idea:** Kamisu Park, after our sister city who has offered Eureka cherry trees



# Kamisu Park

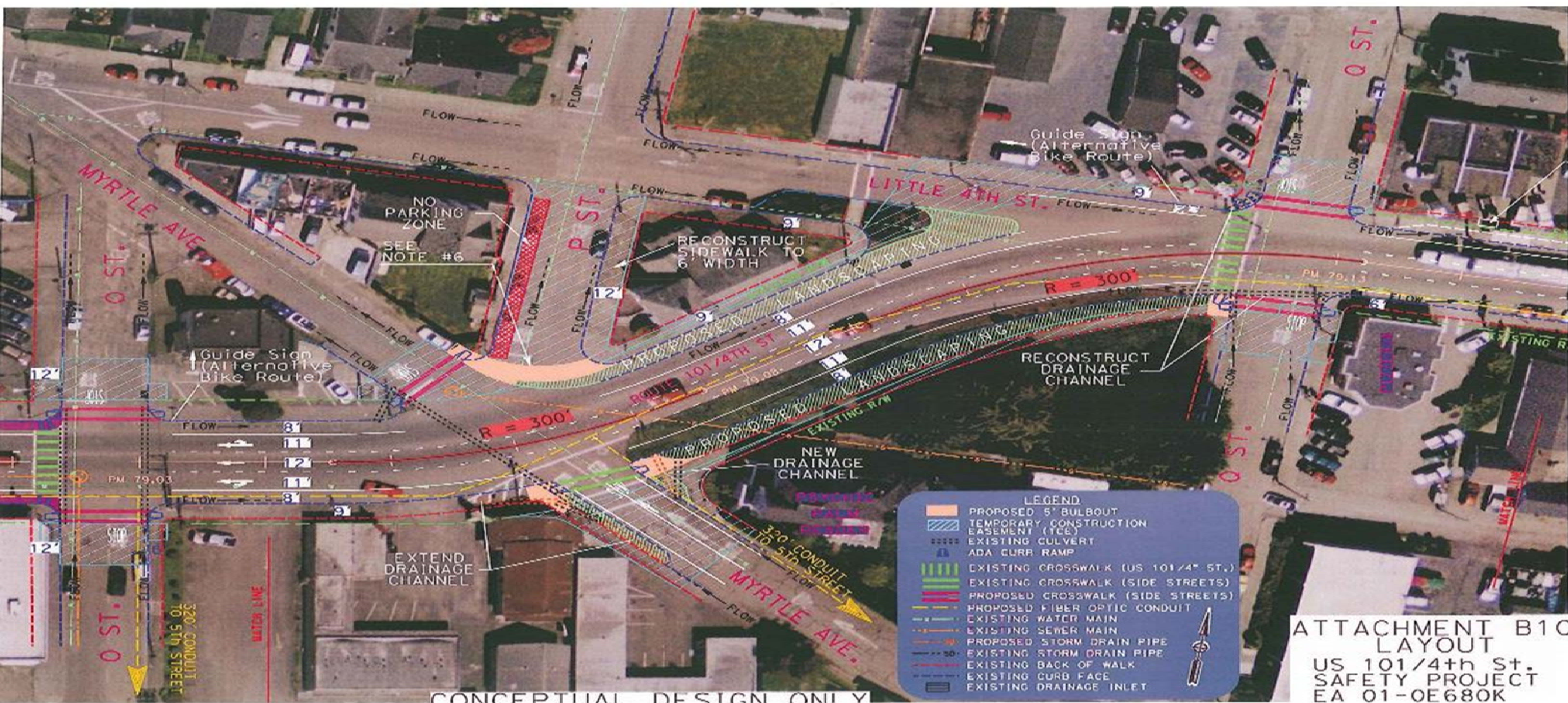



# Broadway and Fairfield



Approximately 4,000 sq. ft.

Highly visible to commuters on Highway 101

Within ~100 feet of a bus stop

Contains a pump station on the southwest corner

**Name Idea:** Coast Guard Park

# Coast Guard Park



# Prior Recommendations

- April 13, 2017, OSPR Commission meeting
  - Dedicating the sites as the “Kamisu Park” and the “Coast Guard Park”; and
  - City Council approve the naming of the two sites as proposed.
- May 8, 2017, Planning Commission meeting
  - Dedicating the sites as the “Kamisu Park” and the “Coast Guard Park”; and
  - City Council approve the naming of the two sites as proposed.





Thank You!